



COOS COUNTY CONDITIONAL USE LAND USE APPLICATION

**SUBMIT TO COOS COUNTY PLANNING DEPT. AT 60 E. SECOND STREET OR MAIL TO:
COOS COUNTY PLANNING 250 N. BAXTER, COQUILLE OR 97423. EMAIL
PLANNING@CO.COOS.OR.US PHONE: 541-396-7770**

If the fee is not included the application will not be processed

(If payment is received on line a file number is required prior to submittal)

Date Received: 4/6/23 Receipt #: 239903 Amount: 1876⁰⁰ Received by: MB

This application shall be filled out electronically. If you need assistance please contact staff.

Applications shall be submitted by the property owner or a purchaser under a recorded land sale contract. "Property owner" means the owner of record, including a contract purchaser.

The application shall include the signature of all owners of the property.

A legal representative may sign on behalf of an owner upon providing evidence of formal legal authority to sign.

LAND INFORMATION

A. Property Owner(s) Eldonna Christie c/o P.O. Box 1548, Bandon, OR 97411

Mailing address: P.O. Box 791, Anahola, HI 96703

Phone: c/o Sheri McGrath 541-982-9531

Email: cooscurry@gmail.com

Township: 29S Range: 15W Section: 1 1/4 Section: C 1/16 Section: B, C Tax lots: 6101

Select Select Select Select Select

Tax Account Number(s): 2956801 Zone: Select Zone Controlled Development (CD)
Tax Account Number(s) Please Select

B. Special Districts and Services

Water City Water Sewage Disposal On-Site Septic
School Bandon Fire District Bandon RFPD

C. Type of Application (s) please consult with staff to determine prior to submittal

- Administrative Conditional Use for Vacation Rental Dwelling
- Hearings Body Conditional Use for _____
- Historical, Cultural and Archaeological Resources, Natural Areas of Wilderness
- Beaches and Dunes
- Non-Estuarine Shoreland Boundary
- Significant Wildlife Habitat
- Natural Hazards
 - Flood
 - Landslide
 - Liquefaction
 - Erosion
 - Wildfires
- Airport Surfaces Overlay
- Variance to which standard _____

Include the supplemental application with all criteria addressed. If you require assistance with the criteria please contact a land use attorney or professional consultant. Property information may be obtained from a tax statement or can be found on the County Assessor's web page at the following links: Map Information Or Account Information ARC, AIR

D. **ATTACHED WRITTEN STATEMENT.** With all land use applications, the “burden of proof” is on the applicant. It is important that you provide information that clearly describes the nature of the request and indicates how the proposal complies with all of the applicable criteria within the Coos County Zoning and Land Development Ordinance (CCZLDO). You must address each of the Ordinance criteria on a point-by-point basis in order for this application to be deemed complete. A planner will explain which sections of the Ordinance pertain to your specific request. The information described below is required at the time you submit your application. The processing of your application does not begin until the application is determined to be complete. An incomplete application will postpone the decision, or may result in denial of the request. Please mark the items below to ensure your submittal is complete.

Application Check List: Please make off all steps as you complete them.

- I. **PROPOSAL AND CRITERIA:** A written statement of intent, attached to this application, with necessary supporting evidence which fully and factually describes the following:
1. Project summary and details including time limes.
 2. A complete explanation of how the request complies with the applicable provisions and criteria in the Zoning Ordinance. A planner will explain which sections of the Ordinance pertain to your specific request. You must address each of the Ordinance criteria on a point-by-point basis in order for this application to be deemed complete. This shall be addressed on the supplemental criteria page (see staff for criteria).
- II. **PLOT PLAN OR SKETCH PLAN:** A detailed drawing delineating the following:
- Owner's name, address, and phone number, map and Tax lot number
 - North Arrow and Scale - using standard engineering scale.
 - Accurate shape and dimensions of parcel, development site, including the lengths of the all property lines.
 - Any adjacent public or private roads, all easements and/or driveway locations. Include road names. Driveway location and parking areas, including the distance from at least one property line to the intersection of the driveway and the road (apron area);
 - All natural features, which may include, but are not limited to water features, wetlands, ravines, slope and distances from features to structures.
 - Existing and proposed structures, water sources, sewage disposal system and distances from these items to each other and the property boundaries.
- III. **DEED:** A copy of the current deed, including the legal description, of the subject property.
- IV. **CERTIFICATION:** I certify that this application and its related documents are accurate to the best of my knowledge. I am aware that there is an appeal period following the date of the Planning Director's decision on this land use action. I understand that the signature on this application authorizes representatives of the Coos County Planning Department to enter upon the subject property to gather information pertinent to this request. If this application is refereed directly to a hearings officer or hearings body I understand that I am obligated to pay the additional fees incurred as part of the conditions of approval. I understand that I/we are not acting on the county's behalf and any fee that is a result of complying with any conditions of approval is the applicants/property owner responsibility. I understand that conditions of approval are required to be complied with at all time and an violation of such conditions may result in a revocation of this permit. If the property owner would like staff to contact a legal representative or consultant please provide the contact information using a consent form.

PROPERTY OWNER SIGNATURES REQUIRED FOR PROCESSING

Eldonna Christie

[Signature]

ACCESS INFORMATION

The Coos County Road Department will be reviewing your proposal for safe access, driveway, road, and parking standards. There is a fee for this service. If you have questions about these services please contact the Road Department at 541-396-7660.

Property Address: 87116 Saturn Lane, Bandon

Type of Access: County Road Name of Access: Saturn Lane

Is this property in the Urban Growth Boundary? Yes

Is a new road created as part of this request? No

Required parking spaces are based on the use of the property. If this is for a residential use two spaces are required. Any other use will require a separate parking plan submitted that is required to have the following items:

- Current utilities and proposed utilities;
- Roadmaster may require drawings and specs from the Oregon Standards Specification Manual (OSSC) (current edition).
- The location and design of bicycle and pedestrian facilities shall be indicated on the site plan if this is a parking plan;
- Location of existing and proposed access point(s) on both sides of the road where applicable;
- Pedestrian access and circulation will be required if applicable. Internal pedestrian circulation shall be provided in new commercial, office, and multi-family residential developments through the clustering of buildings, construction of walkways, landscaping, accessways, or similar techniques;
- All plans (industrial and commercial) shall clearly show how the internal pedestrian and bicycle facilities of the site connect with external existing or planned facilities or systems;
- Distances to neighboring constructed access points, median openings (where applicable), traffic signals (where applicable), intersections, and other transportation features on both sides of the property;
- Number and direction of lanes to be constructed on the road plus striping plans;
- All planned transportation features (such as sidewalks, bikeways, auxiliary lanes, signals, etc.); and
- Parking and internal circulation plans including walkways and bikeways, in UGB's and UUC's.

Additional requirements that may apply depending on size of proposed development.

- Traffic Study completed by a registered traffic engineer.
- Access Analysis completed by a registered traffic engineer
- Sight Distance Certification from a registered traffic engineer.

Regulations regarding roads, driveways, access and parking standards can be found in Coos County Zoning and Land Development Ordinance (CCZLDO) Article 7.

By signing the application I am authorizing Coos County Roadmaster or designee to enter the property to determine compliance with Access, Parking, driveway and Road Standards. Inspections should be made by calling the Road Department at 541-396-7660

Coos County Road Department Use Only

Roadmaster or designee: _____

Driveway

Parking

Access

Bonded

Date:

Receipt # _____

File Number: DR-

SANITATION INFORMATION

If this is a request for a recreational, commercial, industrial, vacation rental, manufactured home park, mass or small gathering Coos Health and Wellness, Environmental Health Staff will be reviewing the proposal to ensure the use meets environmental health standards for sanitation and water requirements to serve the facility. If the proposal indicates that you are using a community water system a review may be required. A fee is charged for this service and shall be submitted with the application \$83.00. If you have questions about regulations regarding environmental health services please call 541-266-6720. This form is required to be signed off for any type of subdivision, recreational, commercial, industrial, vacation rental, manufactured home park, mass or small gathering.

City of Bandon (not an option on drop down)

Water Service Type: Select



Sewage Disposal Type: On-site septic



Please check if this request is for industrial, commercial, recreational or home base business use and complete the following questions:

- How many employees/vendors/patrons, total, will be on site?
- Will food be offered as part of the an on-site business?
- Will overnight accommodations be offered as part of an on-site business?
- What will be the hours of operation of the business?

Please check if the request is for a land division.

Coos County Environmental Health Use Only:

Staff Reviewing Application: _____

Staff Signature: _____

- This application is found to be in compliance and will require no additional inspections
- This application is found to be in compliance but will require future inspections
- This application will require inspection prior to determining initial compliance. The applicant shall contact Coos Health and Wellness, Environmental Health Division to make an appointment.

Additional Comments:

The vacation rental will not have employees. The cleaning person and management will be there as needed and most likely when the rental is not rented.

Plot Plan
The grid for the plot plan is found on the next page

SAMPLE PLOT PLAN

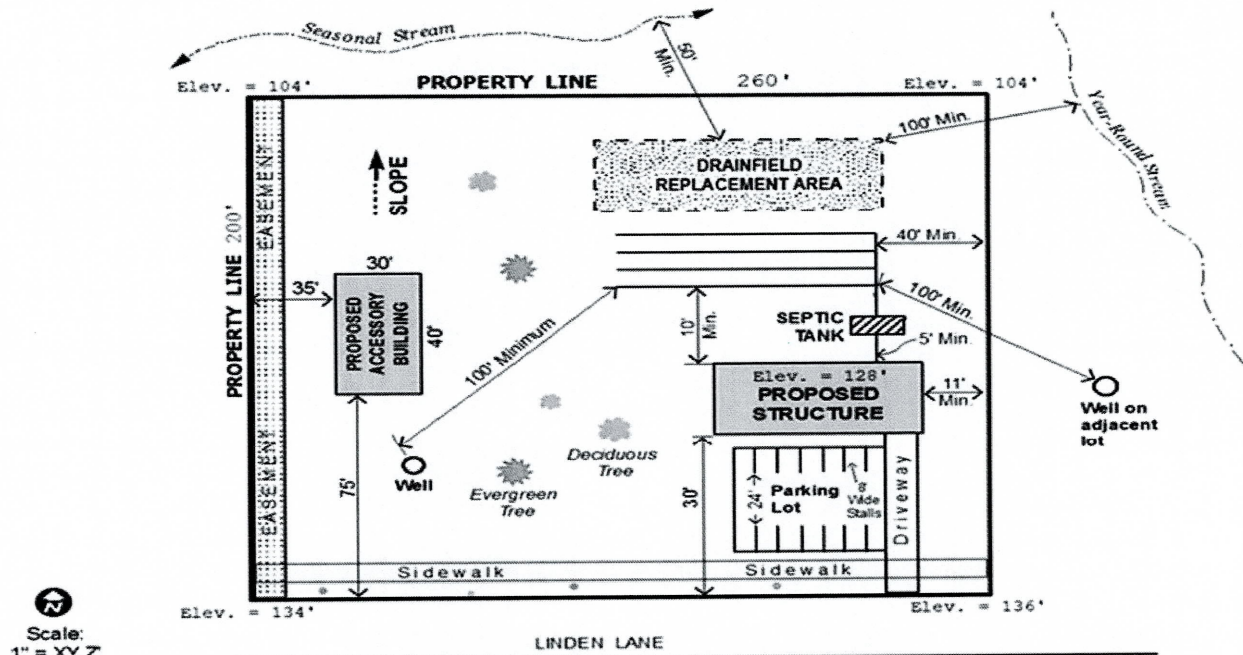

ITEMS THAT MUST BE ON THE PLOT PLAN:

At a minimum, the site plan should provide information on the following items:

- Existing and proposed lot lines, lot or parcel numbers, and acreage/square footage of lots.
- Dimensions of all illustrated features (i.e. all structures, septic systems, driveways, roads, etc.)
- Significant natural features (slopes greater than 20%, geologic hazards, wetlands, drainage ways, rivers, streams, and the general location of existing trees, etc.).
- Existing easements (access, storm drainage, utility, etc.).
- Existing and proposed (structures, outbuildings, septic, etc.) on site and on adjoining properties.
- Existing and proposed road locations including widths, curbs, and sidewalks.
- Existing and proposed driveway approach locations on site, existing driveway approaches on adjoining properties on the same side of the street, and existing driveway approaches across the street from the site.
- Contiguous properties under the same ownership.
- General predevelopment topographical information (minimum 10' contour intervals).
- Location of utilities.
- If redevelopment is viable in the future, a redevelopment plan should be included.
- Preliminary site utility plan.
- Please add any additional Road or parking items from the parking form.

**ADDITIONAL DRIVEWAY, ROAD, PARKING STANDARDS
DRIVEWAY STANDARDS DRAWING – SINGLE RESIDENCE**

Sight Distance Requirements (at the approach entrance)

- Speed less than 35 mph – 100' both directions
- Speed greater than 35mph – 150' both directions

All Weather Surface – minimum 4 – inches aggregate base or as required by Roadmaster.

Figure 7.1.425

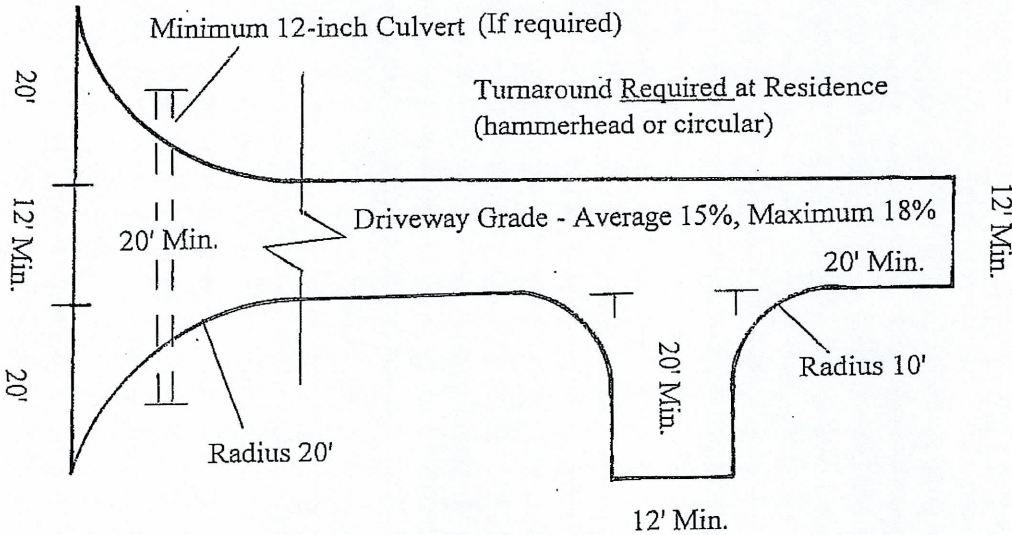

Construct appropriate ditches to prevent water runoff from discharging from the land onto a public road under county jurisdiction. Pursuant to ORS 368.256 the creation of a road hazard prohibited.

If driveway is over 1,000 ft., a pullout is required every 600 ft.

If a driveway cannot meet the maximum 18% grade then a legal agreement may be signed and recorded at the County Clerk's office releasing the County from any liability from such driveway development. This document must be referenced on the property deed to allow future purchasers know that the driveway does meet standard. A sign shall be placed at the bottom of the driveway to warn any users of the driveway that it is not built to standard. Proof must be filed with the Planning and Road Department that the documents have been filed and a sign has been placed. The form located on the following page must be completed, signed and recorded prior to any land use authorizations.

RURAL FIGURES

Driveways Single Residence Figure 1

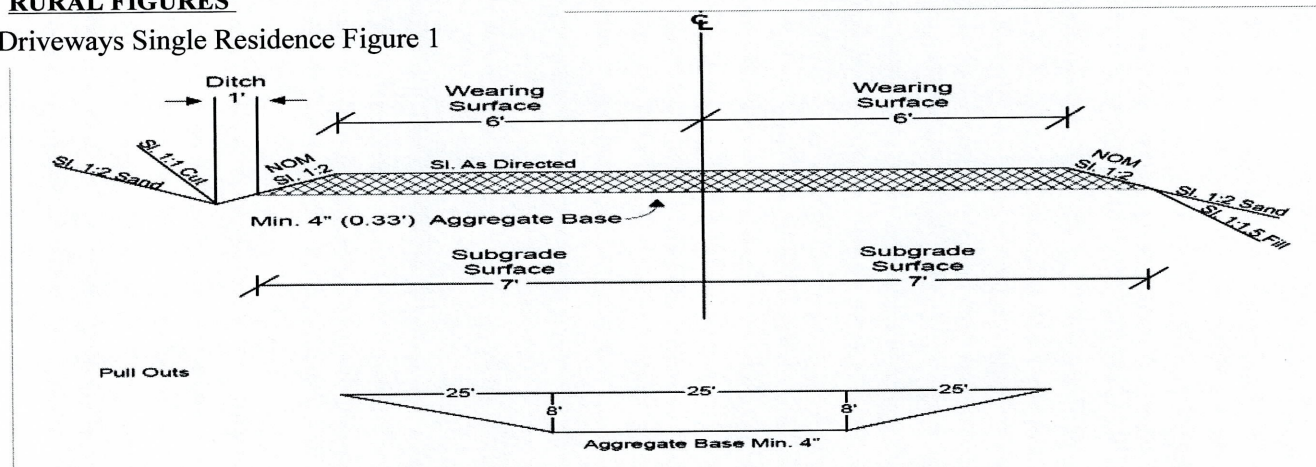

FORESTRY, MINING OR AGRICULTURAL ACCESS:

A private road which is created to provide ingress or egress in conjunction with the use of land for forestry, mining or agricultural purposes shall not be required to meet minimum road, bridge or driveway standards set forth in this ordinance, nor are such resource-related roads, bridges or driveways reviewable by the County. However, all new and re-opened forestry, mining or agricultural roads shall meet the access standards listed in this section.

Forestry, Mining or Agricultural Access Standard drawing

Sight Distance Requirements (at the approach entrance)

- Speed less than 35 mph – 100’ both directions
- Speed greater than 35 mph – 150’ both directions

All Weather Surfaces – minimum aggregate base as required by the Roadmaster
 The access will be developed from the edge of the developed road.

Figure 7.1.450

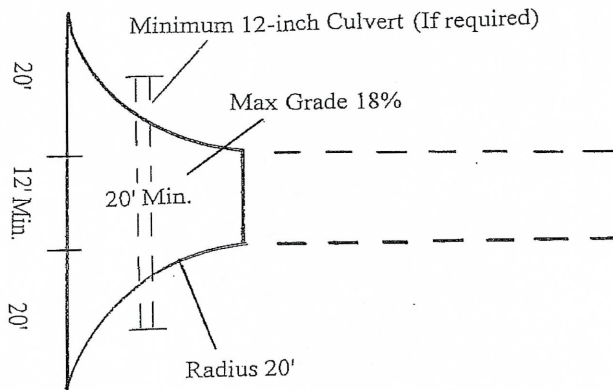

Construct appropriate ditches to prevent water runoff from discharging from the land onto a road under county jurisdiction. Pursuant to ORS 368.256 creation of a road hazard is prohibited.

VISION CLEARANCE TRIANGLE:

The following regulations shall apply to all intersections of streets and roads within all districts in order to provide adequate visibility for vehicular traffic. There shall be no visual obstructions over thirty-six (36) inches in height within the clear vision area established herein. In addition to street or road intersections, the provisions of this section shall also apply to mobile home park, recreational vehicle park, and campground accesses (entrances or exists).

The clear vision area shall extend along the right-of-way of the street for a minimum of 100 feet where the speed limit is less than 35 M.P.H.; and not less than 150 feet where the speed limit is greater than 35 m.p.h. The clear vision area shall be effective from a point in the center of the access not less than 25 feet back from the street right-of-way line.

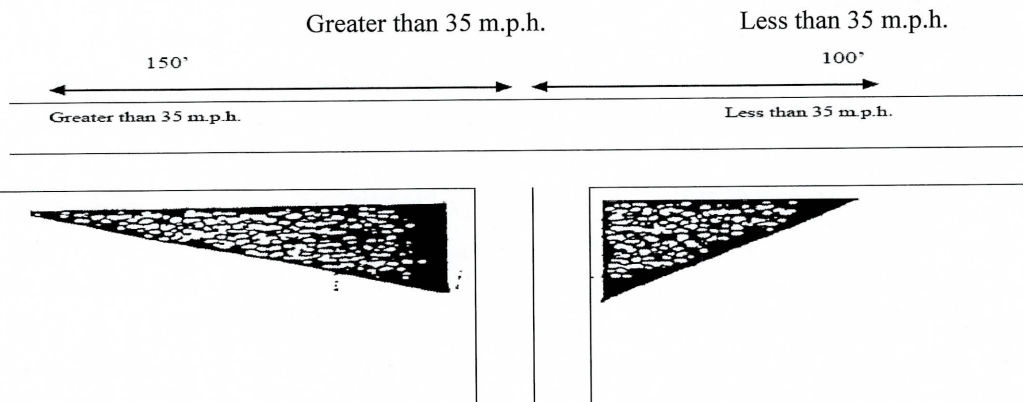

PARKING STANDARDS

USE	STANDARD
Retail store and general commercial except as provided in subsection b. of this section.	1 space per 200 square feet of floor area, plus 1 space per employee. 1 Bicycle space
Retail store handling bulky merchandise (furniture, appliances, automobiles, machinery, etc.)	1 space per 600 square feet of floor area, plus 1 space per employee. 1 Bicycle space
Bank, general office, (except medical and dental).	1 space per 600 square feet of floor area, plus 1 space per employee. 1 Bicycle space
Medical or dental clinic or office.	1 ½ space per examination room plus 1 space per employee. 1 Bicycle space
Eating or drinking establishment.	1 space per 200 square feet of floor area, plus 1 space for every 4 seats. 1 Bicycle space
Bowling Alley	5 spaces per alley plus 1 space per 2 employees. 1 Bicycle space
Dance hall, skating rink, lodge hall.	1 space per 100 square feet of floor area plus 1 space per 2 employees. 1 Bicycle space
Stadium, arena, theater, race track	1 space per 4 seats or every 8 feet of bench length or equivalent capacity if no seating is provided. 1 Bicycle space
Storage warehouse, manufacturing establishment, or trucking freight terminal	1 space per employee. 1 Bicycle space
Wholesale establishment.	1 space per employee plus 1 space per 700 square feet of patron serving area. 1 Bicycle space
Welfare or correctional institution	1 space per 5 beds for patients or inmates, plus 1 space per employee. 1 Bicycle space
Convalescent hospital, nursing home, sanitarium, rest home, home for the aged.	1 space per 5 beds for patients or residents, plus 1 space per employee. 1 Bicycle space
Church, mortuary, sports arena, theater.	1 space for 4 seats or every 8 feet of bench length in the main auditorium. 1 Bicycle space
Library, reading room.	1 space per 400 square feet of floor area plus 1 space per employee. 1 Bicycle space
Preschool nursery, kindergarten.	2 spaces per teacher; plus off-street loading and unloading facility. 1 Bicycle space per 20 students
Elementary or junior high school.	1 space per classroom plus 1 space per administrative employee or 1 space per 4 seats or every 8 feet of bench length in the auditorium or assembly room whichever is greater. 1 Bicycle space per 10 students
High school	1 space per classroom plus 1 space per administrative employee plus 1 space for each 6 students or 1 space per 4 seats or 8 feet of bench length in the main Auditorium, whichever is greater. 1 Bicycle space per 20 students

Other auditorium, meeting room.	1 space per 4 seats or every 8 feet of bench length. 1 Bicycle space
Single-family dwelling.	2 spaces per dwelling unit.
Two-family or multi- family dwellings.	1 ½ spaces per dwelling unit. 1 bicycle space per unit for buildings with 4 or more units.
Motel, hotel, rooming or boarding house.	1 space per guest accommodation plus 1 space per employee.
Mobile home or RV park.	1 ½ spaces per mobile home or RV site.

Parking lot standards – Use the table above along with the area available to calculate the number of spaces required and determine the type of parking lot that needs to be created. The table below explains the spacing and dimensions to be used.

Minimum Horizontal Parking Widths for Standard Automobiles					
	One-way Parallel	30 deg	45 deg	60 deg	90 deg
Figures	A	B	C	D	E
Single row of Parking					
Parking Aisle	9'	20'	22'	23'	20'
Driving Aisle	12'	16'	17'	20'	24'
Minimum width of module (row and aisle)	21'	36'	39'	43'	44'
Figures #'s	F	G	H	I	J
Two Rows of Parking					
Parking Aisle	18'	40'	44'	46'	40'
Driving Aisle	12'	16'	17'	20'	24'
Minimum width of module (row and aisle)	30'	56'	61'	66'	64'

For figures please see Coos County Zoning and Land Development Ordinance (CCZLDO) § 7.5.175.

Please note: If you are developing in any wetlands or floodplain please contact Department of State Lands to ensure you are not required to obtain a state permit.

Sheri McGrath, Inc
Coos Curry Consulting
P.O. Box 1548 * Bandon, Oregon 97411
cooscurry@gmail.com
541-982-9531

CONSENT FOR REPRESENTATION

I, Eldonna Christie of P.O. Box 791, Anahola, HI 96703
give permission to Coos Curry Consulting Group to represent me on all design, permit
and consulting matters concerning the property located on Coos County Tax Assessor's
Map 29-15-01CC TL 6101. The tax account for this property is 2956801. The situs
address is 87116 Saturn Ln, Bandon, OR 97411.

Sheri McGrath is the direct contact for all permit application questions, plan review
comments, concerns or questions, and any other information related to the above
property.

Contact information for Sheri McGrath is:

Cell: 541-982-9531
E-mail: cooscurry@gmail.com
Mailing address: P.O. Box 1548, Bandon, OR 97411

This consent automatically expires eighteen months from the date below, without
requirement of notice.

DATED: February 24, 2023

COOS CURRY CONSULTING

By: SHERI MCGRATH

CLIENT

By: ELDONNA CHRISTIE

COOS County Assessor's Summary Report

Real Property Assessment Report

FOR ASSESSMENT YEAR 2021

October 23, 2021 3:56:15 pm

Account # 2956801 Map # 29S1501CC06101 Code - Tax # 5403-2956801 Legal Descr See Record Mailing Name CHRISTIE FAMILY TRUST Agent In Care Of CHRISTIE, ELDONNA M TTEE Mailing Address PO BOX 791 ANAHOLA, HI 96703-0791 Prop Class 101 MA SA NH Unit RMV Class 101 06 29 BLR 28215-1	Tax Status ASSESSABLE Acct Status ACTIVE Subtype NORMAL Deed Reference # 2017-9923 Sales Date/Price 09-25-2017 / \$0.00 Appraiser SUSAN VINEYARD
---	---

Situs Address(s)	Situs City
ID# 87116 SATURN LN	BANDON

Code Area		Value Summary					RMV Exception	CPR %
		RMV	MAV	AV	SAV	MSAV		
5403	Land	367,760					Land	0
	Impr.	72,840					Impr.	0
Code Area Total		440,600	148,800	148,800	0	0		0
Grand Total		440,600	148,800	148,800	0	0		0

Code Area	ID#	RFPD	Ex	Plan Zone	Value Source	Land Breakdown			Land Class	LUC	Trended RMV
						TD%	LS	Size			
5403	10	<input checked="" type="checkbox"/>		CD-10	Market	112	A	0.28	MISC	001	367,760
Grand Total								0.28			367,760

Code Area	ID#	Yr Built	Stat Class	Description	Improvement Breakdown			Total Sq. Ft.	Ex% MS Acct #	Trended RMV
					TD%					
5403	1	1992	155	Garage-Class 5	112		0		72,840	
Grand Total								0	72,840	

Appr Maint: 2021 - OTHER NEW CONSTRUCTION (SINGLE FAMILY DWELLING)